



QUICK START GUIDE

Sveaverken Blix Robotic Lawn Mower

* **ATTENTION:** This Quick Start Guide is not a replacement for the User Manual. The complete User Guide contains other important information about your robotic lawn mower. Misuse, improper assembly, or lack of maintenance can make your robotic lawn mower unsafe for use. You can find general information on care and inspection, recommended practices, and service and maintenance tips in the User Manual.



Watch the video tutorial here

01. What's in the Box



Robotic Lawn Mower



Charging Station



Weather Shed



Wheel Spikes



Power Cables



Power Adapter



Plastic Pegs

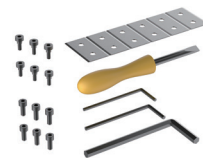

Tool Set

02. Install Charging Station

- 1 Place the charging station and the weather shed on a flat surface. **Both are needed** for the mower to recognize its way back. There needs to be a **2 meter (6 feet) radius** around the charging station for the mower to have enough clearance and be able to position and return home accurately.

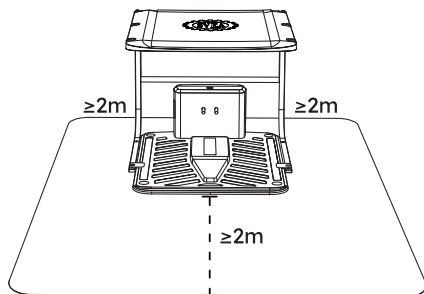

- 2 Secure the charging station with pegs.

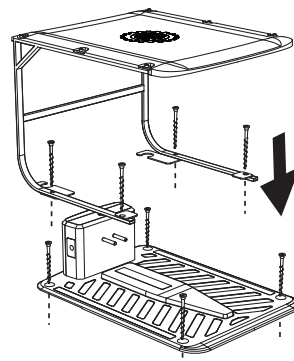

- 3 Plug in the power cable.

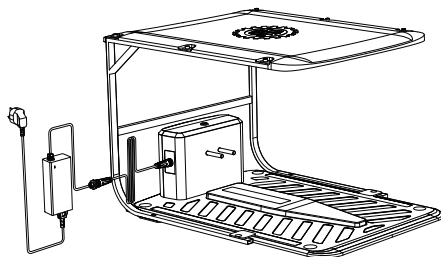

- 4 Place the mower in the charging station and turn on to charge. The power button is under the handle.

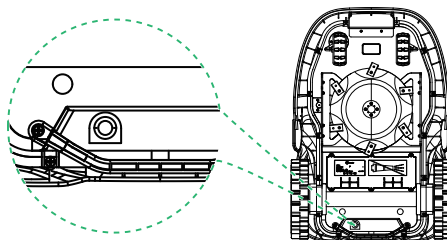

03. Connect app & pair the mower

- 1 Download the SveaMow app.



- 2 Turn on Bluetooth and pair the mower with your phone.

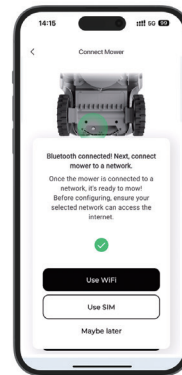
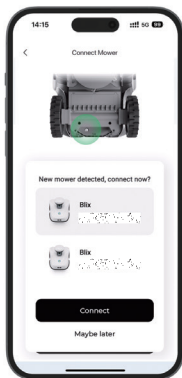

04. Map & Mow

- 1 Go to "Manage Mower" and start mapping your lawn.

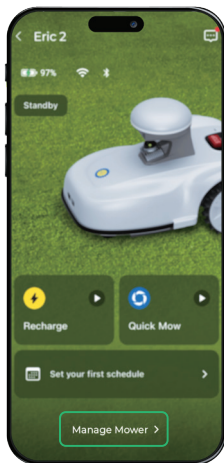

- 2 Use the virtual joysticks on your phone to drive the mower along the boundaries of the work zones and no-go zones.



- 3 Start a quick mow mission or schedule a future mission.

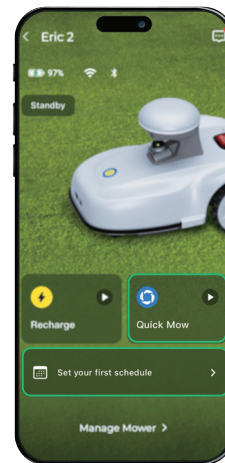

Happy Mowing with Sveaverken Blix!